



The Totteridge Academy

The best in everyone™

Part of United Learning

The Totteridge Academy Sixth Form



Open Evening Event Guide
Thursday 10th November 2022
Start time: 5:30pm



Dear Students, Parents and Carers,

A very warm welcome to our Sixth Form Open Evening! This evening, you will meet our fantastic students and teachers, ask questions about our courses, and find out more about our close-knit community.

This summer, our Year 13s graduated with an excellent set of A Level results and university offers: **32% of students achieved A* or A grades, 54% of entries received A*-B grades and 87% of entries received A*-C grades.** These have allowed our students to move on with fantastic results setting them up for their next steps in life.

It is not just that, however, that makes me proud to be Principal here, it is the culture at TTA. This school community is one that promotes kindness and collaboration, celebrates success, consistently maintains high expectations, and believes in continuous improvement: 'kaizen'. As I always say, it is vital to work hard, aim high, and be kind. This is what TTA is all about and I am glad you are here to see it for yourselves.

This evening, please don't leave without:

- Visiting the subject areas (see the Event Map for full details);
- Attending my talk at 6:30pm in the Main Hall;
- Putting in an early Sixth Form Application in the Learning Resources Centre;
- Asking our students and staff any questions you have.

This booklet contains full details of the A-levels we will be offering, including course content, entry criteria and career pathways, as well as some common FAQs regarding the application process and life in the Sixth Form.

We are thrilled to welcome you and look forward to helping you make informed, ambitious choices about your future.

Have a fantastic evening!

Chris Fairbairn – Principal



Welcome to our Sixth Form Open Evening 2022 5:30pm-7:00pm

Timings for this evening:

5:30pm-6:30pm:

- **A chance to visit department areas**
- **Talk to the Sixth Form team**
- **Visit the LRC and put in an early application**

6:30pm:

- **Presentations from Chris Fairbairn, Principal, and Jeremy Whipp, Director of Sixth Form**



Our team of Sixth Form leaders would also like to add they are also delighted to welcome you to our Sixth Form open evening.

We will be available to answer any questions you have about our fantastic Sixth Form throughout the evening.



**Mr Whipp –
Director of
Sixth Form**



**Mr Abiola –
Deputy Director
of Sixth Form**



**Dr Beck – Lead
Tutor for
Progression**



Visit the subject areas in the Main Building

Conference Room

T1

T5

LRC

A1

A2

A3

Director and Deputy Director of Sixth Form, Economics, Sociology/R.S.
Maths, Further Maths, Comp. Science
Product Design
Applications for Sixth Form
Geography & MFL
Art & PE
Theatre Studies

Library

'Humanities hub'
History
Politics
English Literature

Foyer
Refreshments

**Presentation from the Principal and Director of Sixth Form
Main Hall - 6:30pm**

Lab 3

Chemistry
Psychology
Biology
Physics

Lab 2

Exit

You are here!

Sixth Form Study Room

Collect Event Guide

Main Reception

Arrival & Registration

Car Park

Front Gate

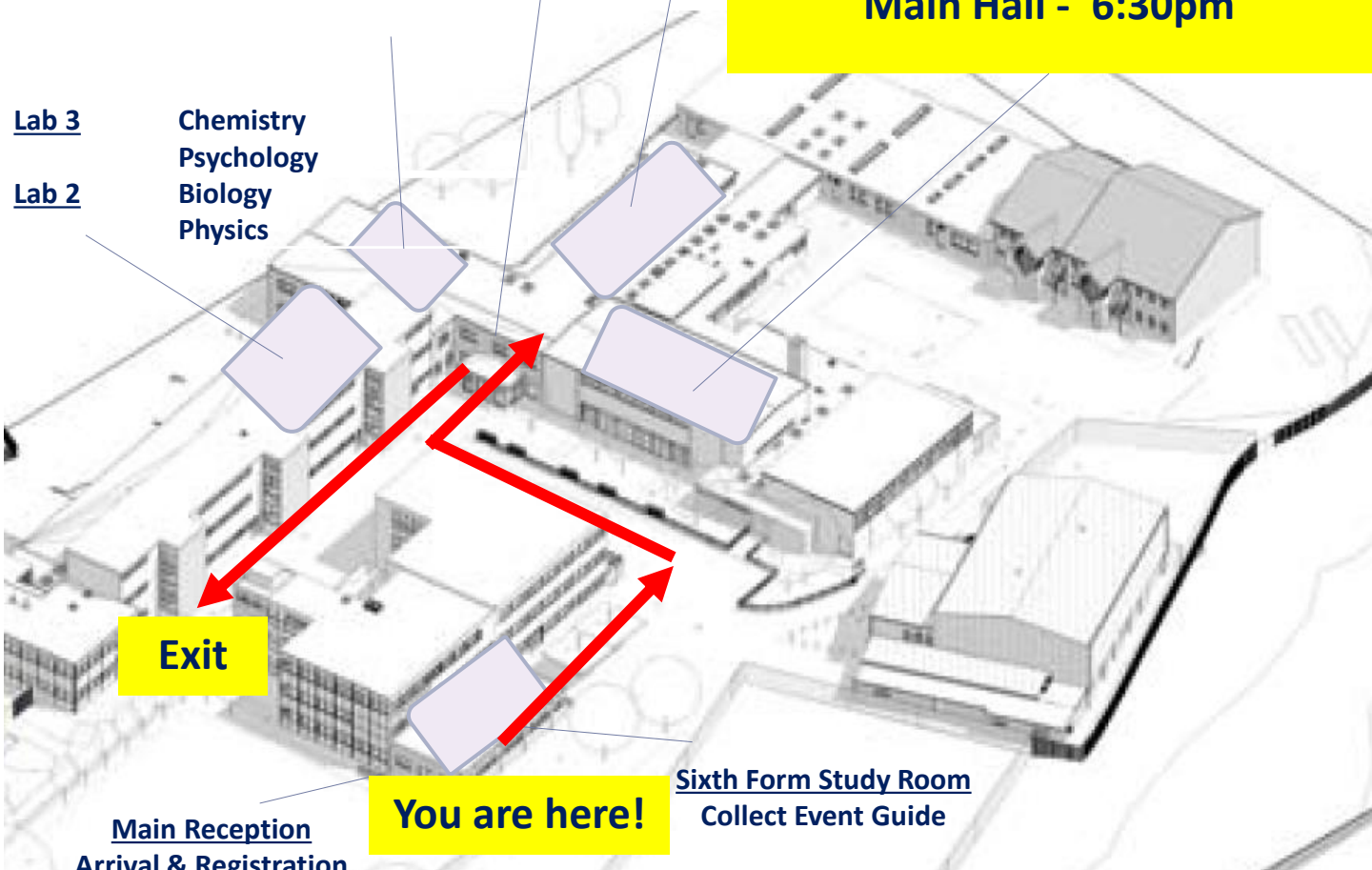



**The qualification we offer is:
AQA A-Level Art & Design**

In Y12 you will study:

- In Component 1, students produce an extended collection of work that exemplifies aspects of their developing knowledge, skills and understanding.
- In Component 2, students respond to a stimulus, provided by AQA, to produce work which provides evidence of their ability to research and develop ideas and to make clear the link between their own and others' work.

Choose Art & Design if you like:

Choose Art & Design if you're keen to turn ideas into reality, drawing inspiration from the work of others and developing new skills along the way. On the course, you will explore a range of processes and techniques, both traditional and new media. You will use drawing for different purposes and will explore relevant images, artefacts and resources relating to a range of art, craft and design, from the past and from recent times and from across cultures.

An A-level in Art & Design can lead to:

The Art and Design course is flexible and stimulates creativity, offering a high degree of choice and a range of different media, processes and techniques. This A-level will give students the opportunity to produce a portfolio of work that they can show to prospective employers or use to help secure a place in higher education. The course might take you to Art School, or a university degree in a design-related discipline.

An example exam question is:

The spirit of Art Deco Art Deco artists, designers and architects often used stylisation, colour and geometric pattern in their work. Sunbursts, waterfalls, clouds, flora and fauna were common features. Research appropriate examples and produce a personal response.
[96 marks]

Homework:

Ongoing artist research, design enquiry and portfolio development as directed by teacher

Entry Criteria –

TBC; based on performance in GCSE and design portfolio



The qualification we offer is:

AQA A-Level Biology

In Y12 you will study:

- Biological molecules
- Cells
- Exchange of substances between organisms and their environment
- Genetic information, variation and relationships between organisms

Choose Biology if you like:

Choose Biology if you like delving into the natural world and the processes that dictate how all living organisms survive, compete and reproduce. Biology is a challenging course and will push your conceptual thinking in deciphering complicated processes like the Krebs Cycle, but also deeply mathematical in its use of sophisticated mathematical and statistical techniques to better understand how organisms can interact with their environment.

An A-level in Biology can lead to:

Biology leads to a great many courses and careers. Many students with Biology A-Level will go on to study medicine, biomedical sciences or vocations like nursing or dietetics. Many students will continue to study science beyond University, becoming practising field scientists in diverse areas like microbiology, genetic engineering and ecosystems management.

An example exam question is:

Starting with mRNA in the cytoplasm, describe how translation leads to the production of a polypeptide.

Do not include descriptions of transcription and splicing in your answer.

Homework:

Homework will be based on extensive amounts of practice, including worksheets, knowledge quizzes and past paper questions.

Entry Criteria –

**Grade 7 in Biology GCSE or
7-7 in Combined Science GCSE**



The qualification we offer is:
AQA A-Level Chemistry

In Y12 you will study:

- Physical chemistry (atomic structure energetics, kinetics)
- Inorganic chemistry (groups in the periodic table)
- Organic chemistry (alkanes, alkenes, alcohols, halogenoalkanes etc.)
- Quantitative chemistry (moles and amount of substance, ideal gas law)

Choose Chemistry if you like:

Choose Chemistry if you like pushing your understanding of the basic processes that occur all around us everyday. Chemistry is an incredibly challenging course, but it is also a hugely rewarding one, covering a vast number of topics in its range of content. Substance will vary from the abstractions of Le Chatelier's principles to the concrete realities involved in industrial drug manufacture and atmospheric processes involving ozone and CFCs.

An A-level in Chemistry can lead to:

In addition to being an important prerequisite for medicine, chemistry is a highly sought after A-Level and can lead to a great many options at university and further study. Within chemistry, students often go on to study straight chemistry, chemical engineering or biochemistry. From there, careers in research or industry are an easy step.

An example exam question is:

Some toothpastes contain sodium fluoride. The concentration of sodium fluoride can be expressed in parts per million (ppm). 1 ppm represents a concentration of 1 mg in every 1 kg of toothpaste.

A 1.00 g sample of toothpaste was found to contain 2.88×10^{-5} mol of sodium fluoride.

Calculate the concentration of sodium fluoride, in ppm, for the sample of toothpaste.

Homework:

Homework will be based on extensive amounts of practice, including worksheets, knowledge quizzes and past paper questions.

Entry Criteria –

**Grade 7 in Chemistry GCSE
or 7-7 in Combined Science**



**The qualification we offer is:
AQA A-Level Computer Science**

In Y12 you will study:

- Theory – Software and Hardware, Data Representation, Compression, Encryption, Boolean Logic, Classifications of Programming Languages, Compilers.
- Programming – Procedural, Object Oriented & Event Driven Programming.
- Software Engineering principles and introduction to your NEA project.

Choose Computer Science if you like:

Choose Computer Science if you like learning about the technologies that underpin all modern computers and digital systems. You will be challenged to constantly use computational thinking to solve problems, and apply theory and creativity to create robust programs. The subject also requires you analyse technology and how it can impact society.

An A-level in Computer Science can lead to:

Any degree or further study associated with science, technology, engineering, and mathematics (STEM). Computational thinking can apply to all STEM opportunities, and many are increasingly including programming as well. Graduates with computer science skills are highly sought after in many industries.

An example exam question is:

A company providing a social media service uses algorithms to select news stories for users written by other organisations and individuals.

Discuss:

- *how algorithms might determine which current affairs news stories to display to an individual member*
- *the moral, ethical and legal considerations that the developers of the system and its operators should consider in relation to how the algorithms work and which news stories are displayed.*

Homework:

Regular programming practice, online exam question practice, self-study and research tasks.

Entry Criteria –

**Grade 6 in Computer Science or
Grade 7 Maths GCSE.**



The qualification we offer is:

OCR A Level Economics

You will study:

Microeconomics: Microeconomics looks at the nature of economics, how markets work and fail, how governments intervene to solve these failures, and how labour markets work.

Macroeconomics: Macroeconomics looks at measures of economic performance, the causes and consequences of economic growth, unemployment, inflation and trade imbalances. We study how governments use macroeconomic policy to manage the economy, how the financial system works and is regulated.

Choose Economics if you like:

Asking questions and understanding how the world works.

Economists will develop their analytical, numeracy, evaluative and reasoning skills focusing on current issues in the modern world.

Lessons will involve investigating contemporary issues from an Economic perspective and will suit students who enjoy discussion and developing their written and analytical skills, specifically using evidence and data to form compelling analyses and deliver reasoned arguments.

An A-level in Economics can lead to:

Anything you want it to. Investment banking, financial management, consultancy, economic analysis, research, journalism, the list goes on. Economists build a wide range of transferable skills which are highly prized by both universities and employers.

Example exam questions:

1. *In July 2016 Apple's share of the UK market for smartphones was 38%. Evaluate whether such a high market share for one company is in the consumer interest. Use appropriate diagrammatic analysis in your answer.*

2. *Evaluate the view that 'a degree of inequality is desirable to maintain appropriate incentives in the economy'*

Homework:

- Practice exam questions on topics studied in class
- Weekly reading/video watching and analysis of current economic issues

Entry Criteria –

Grade 6 in both GCSE English and Maths



The qualification we offer is:
Edexcel A level English Literature

Throughout the course you will study:

- Drama: Tragedy – Shakespeare's '**Othello**' & Williams' '**A Streetcar Named Desire**'.
- Prose: 'Women in Society' - Hosseini's **A Thousand Splendid Suns** & Bronte's **Wuthering Heights**.
- Poetry: **The Book of Victorian Verse**.
- '**Poems of the Decade**' Modern Anthology.

Choose English Literature if you like:

An A-level in English Literature will challenge you to read widely, think and write critically and to understand texts as products of their time. Choose this subject if you're keen to develop original, independent interpretations through research and to engage in lively intellectual debates with peers.

An A-level in English Literature can lead to:

An A-level in English Literature will open doors to a range of industries including journalism, media, law, publishing, marketing, advertising, politics, consultancy, and the charity sector. However, the focus on independent thought and self-directed learning helps to prepare you for undergraduate study in any discipline.

An example exam question is:

- 1. Explore** how Shakespeare treats the theme of identity in *Othello*. You must relate your discussion to relevant contextual factors and ideas from your critical reading.
- 2. Compare** how both authors of *Wuthering Heights* and *A Thousand Splendid Suns* present ideas about death. You must relate your discussion to relevant contextual factors and ideas from your critical reading.

Homework:

- Weekly reading of set texts and completion of reading logs prior to lessons.
- Weekly planning, writing and redrafting of essays on set texts.

Entry Criteria:

Grade 7 in English Literature GCSE



The qualification we offer is:

AQA Extended Project Qualification

In Y12 you will study:

A dissertation (usually 5,000 words) or a project (an event like a charity fundraiser, piece of art or sculpture, a performance, a piece of music) accompanied by a 1,000 word report on a topic decided by you.

Choose EPQ if you like:

The EPQ allows you to develop a personal interest in a topic you care about. The skills you'll develop as a result of doing the EPQ (project planning, decision making, record keeping, evaluation, presenting) are invaluable in most jobs and degree courses.

An EPQ can lead to:

An EPQ can help when applying for university as it demonstrates your commitment to a subject and allows you to develop the independent research skills needed for undergraduate study. If you're invited to interview, an EPQ will provide you with a topic to speak about at length, with passion and conviction.

Example EPQ questions:

- *How effective was the NHS' response to the 2020 Corona virus in the U.K?*
- *How can weekly boxing improve female students' attendance and academic attainment in Key Stage 3?*
- *Is the London Living Wage good for the economy?*

Homework:

- Planning and research log
- Preparation for meetings with your supervisor to discuss progress
- Presentations to EPQ group on your progress

Entry Criteria –

Dependent on student's area of interest



The qualification we offer is:

AQA A Level French

In Y12 you will study:

1. Social issues and trends
2. Political and artistic culture
3. Grammar

Choose French if you like:

An A level in French will build upon your existing knowledge gained at GCSE, giving you a sound understanding of using your language in a variety of contexts and situations - at home, abroad, with friends or in the workplace. It will also introduce you to the wonders of French literature and film.

An A-level in French can lead to:

French is the mother tongue of about 100 million people across the world. Being able to speak French can provide you with a multitude of travel and work opportunities. The qualification is viewed favourably across business, arts, travel and legal sectors as well as in politics and translation. French can be taken in conjunction with many other humanities subjects at degree level, or as a stand-alone course.

Example exam question:

Analysez comment le comportement d'Orgon est influencé par son obsession avec le pouvoir et le contrôle. [40 marks]

Analysez la représentation de la banlieue et des banlieusards dans ce film et combien cette représentation est réaliste. [40 marks]

Homework:

- Weekly comprehension & extended writing tasks
- Vocabulary learning
- Oral practice where relevant

Entry Criteria –

GCSE French grade 7



The qualification we offer is:

AQA A Level Geography

In Y12 you will study:

- **Physical Geography:** Water & Carbon and Natural Hazards.
- **Human Geography:** Changing Places and Global Systems & Governance
- **Fieldwork Investigation** – You will begin preparing for your fieldwork investigation; this is a 3–4000-word independent essay on an area you have picked from within the Geography A Level Specification.

Choose Geography if you like:

Choose Geography if you're interested in the world around you. Geography is the bridge between the natural and social sciences, providing its own specialist knowledge and skills and the valuable interdisciplinary approaches needed to address pressing global issues from climate change and migration, to environmental change and social cohesion.

An A-level in Geography can lead to:

A Level Geography is a versatile qualification that is well respected by employers and universities alike. Employers highly value Geography qualifications because Geography students can think logically and analytically. They are accurate and objective in collecting, recording, processing, presenting, analysing and interpreting data.

Example exam question:

Assess the potential causes and impacts of changes to the water balance within a box tropical rainforest that you have studied. [20 marks]

Using Figure 2 and your own knowledge, assess the challenges associated with reducing greenhouse gas emissions. [6 marks]

Homework:

- Reading tasks and accompanying questions
- Preparation for presentations where relevant
- Exam style questions where relevant

Entry Criteria –

GCSE grade 6 in Geography.



The qualification we offer is:
Edexcel A Level History

In Y12 you will study:

Paper 1: Russia 1917-91, from Lenin to Yeltsin

From revolution to the collapse of the Soviet Union, you will study Russia's twentieth century and investigate the political, economic and social features of communist rule.

Paper 2: The German Democratic Republic, 1949-90

From its creation to its demise, you will study what life was like 'behind the Berlin Wall', on the frontline of the Cold War, in a country where contrasts between East and West were at their starkest.

Choose History if you like:

An A Level in History will equip you to challenge generalised narratives. It will provide you with endless opportunities to handle contemporary evidence critically, using this to corroborate or challenge historians' interpretations of the past and to ask questions about the way that different events have been interpreted. Choose History if you enjoy reading widely, thinking critically and creating your own original arguments.

An A-level in History can lead to:

An A Level in History can lead to a range of different careers including law, politics, journalism, teaching, consultancy, accountancy and the media. However, the focus on independent research and extended writing helps History to be considered as a highly academic A Level which equips you with skills that are both useful for further study of any discipline at undergraduate level and which are desired by many employers.

Example exam question(s):

How far did the role of the secret police change in the Soviet Union through the period 1953-85? [20]

To what extent was Honecker successful in his attempts to improve the international prestige of the GDR? [20]

Homework:

- Weekly extended reading (often of historians' work) and questions
- Weekly essay

Entry Criteria

Grade 6 in GCSE History



The qualification we offer is:
Edexcel A level Mathematics

In Y12 you will study: Pure Mathematics, Mechanics and Statistics

- Proof
- Algebra and functions
- Coordinate geometry
- Trigonometry
- Exponentials and logarithms
- Differentiation
- Integration
- Statistical sampling
- Data presentation
- Probability
- Kinematics
- Forces and Newton's laws

Choose Mathematics if you like:

A level Mathematics will teach you how to approach complex problems and work through them with logic, creativity and persistence. You will learn how to analyse and interpret data and how to model real-life situations using Mathematics. Choose this subject if you want to stretch your intellect and develop reasoning skills transferable to a multitude of fields.

An A-level in Mathematics can lead to:

Mathematics is one of the most frequently requested A level subjects by universities and opens doors to a huge range of professions. Careers in finance, medicine, engineering, business and economics are all open to people with a background in Mathematics, not to mention it being at the core of all new technological developments.

An example exam question is:

a) Prove that

$$1 - \cos 2\theta \equiv \tan \theta \sin 2\theta, \quad \theta \neq \frac{(2n+1)\pi}{2}, \quad n \in \mathbb{Z} \quad (3)$$

b) Hence solve for $-\frac{\pi}{2} < x < \frac{\pi}{2}$ **the equation**

$$(\sec^2 x - 5)(1 - \cos 2x) = 3 \tan^2 x \sin 2x$$

Give any non-exact answer to 3 decimal places where appropriate. (6)

Homework:

- Practice questions on topics studied in class
- Weekly testing of material
- Exam question practice

Entry Criteria –

Grade 7 in GCSE Mathematics



The qualification we offer is:

Pearson Edexcel A level Further Mathematics

In Y12 you will study: Further Pure Mathematics, and further Mechanics/Statistics or Decision Mathematics

- *Complex numbers*
- *Proof*
- *Matrices*
- *Further Calculus*
- *Hyperbolic functions*
- *Differential Equations*
- *Binomial and Poisson Distributions*
- *Hypothesis Testing*
- *Elastic collisions in two dimensions*
- *Circular motion*
- *Algorithms, linear programming & more*

Choose Further Mathematics if you like:

An A level in Further Mathematics will push your mathematics ability further than ever before. There are many mathematics disciplines and this A-level will give you the opportunity to study further pure mathematics, mechanics and statistics, whilst also allowing you to be exposed to decision mathematics and logic, which is essential to understanding how decisions are made and how computers think.

An A-level in Further Mathematics can lead to:

An A-level in Further Mathematics is designed for pupils wishing to focus on further study at the leading universities for the following disciplines: Mathematics, Physics, Engineering, Computer Science and Economics. This can lead to countless careers such as medical engineering, banking, computer programming and actuary.

An example exam question is:

7.

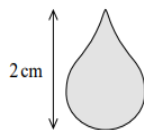

Figure 2

Figure 2 shows the image of a gold pendant which has height 2 cm. The pendant is modelled by a solid of revolution of a curve C about the y -axis. The curve C has parametric equations

$$x = \cos \theta + \frac{1}{2} \sin 2\theta, \quad y = -(1 + \sin \theta) \quad 0 \leq \theta \leq 2\pi$$

(a) Show that a Cartesian equation of the curve C is

$$x^2 = -(y^4 + 2y^3)$$

(b) Hence, using the model, find, in cm^3 , the volume of the pendant.

Homework will be:

- Practice questions on topics studied in class
- Weekly testing of material
- Exam question practice

Entry Criteria –

Grade 8 in GCSE Mathematics



The qualification we offer is:
AQA A-Level Physical Education

In Y12 you will study:

- **Section A:** Applied anatomy and physiology
- **Section B:** Skill acquisition
- **Section C:** Sport and society

Choose Physical Education if you like:

An A-level in Physical Education will enable you to engage with the most in depth elements of sport. The practical aspect is suited to students who are driven towards an elite level of performance, while the theory challenges students who enjoy scientific level analysis, interpretation of data and producing detailed evaluations.

An A-level in Physical Education can lead to:

An A-level in Physical Education offers students the opportunity to make strides in a wide variety of employment areas as well as higher education. While this list is by no means definitive, career paths could include roles in sports science, health and fitness, physiotherapy and rehabilitation, nutrition or coaching.

Example exam questions:

Analyse how cryotherapy aids recovery from exercise by causing the body to redistribute blood flow. (8 marks)

Analyse how campaigns such as 'This Girl Can' might overcome barriers to female participation in sport and change attitudes. (15 marks)

Homework:

- Weekly reading of key material and planning for presentations
- Weekly knowledge recall tasks
- Weekly exam questions (inc. extended writing tasks)

Entry Criteria –

Grade 6 in GCSE PE, alongside teacher review of practical performance



The qualification we offer is:
AQA Physics A-Level

In Y12 you will study:

- Maths for physics, measurements and their errors
- Particles and radiation (including quantum physics)
- Waves
- Mechanics and materials
- Electricity

Choose Physics if you like:

Choose Physics if you like the ongoing human endeavour of coming to grips with the most fundamental mathematical laws that govern our universe. Studying physics will teach you to think logically and solve problems related to the workings of the smallest particles through to the largest stars. Through the synthesis of theoretical and mathematical abstraction with experimental evidence, you will gain an appreciation of the universe that will leave you feeling enlightened and excited to discover more.

An A-level in Physics can lead to:

Physics is a highly-regarded course which will open any door you choose. Most students go on to study engineering (including mechanical, aerospace, civil and electrical engineering), physics (including astrophysics) or maths.

An example exam question is:

Derive an expression to show that for satellites in a circular orbit:

$$T^2 \propto r^3$$

where T is the period of the orbit and r is the radius of the orbit. (2)

Pluto is a dwarf planet. The orbital radius of Pluto around the Sun is 5.91×10^9 km compared to a mean orbital radius of 1.50×10^8 km for the Earth. Calculate in years the orbital period of Pluto. (2)

Homework:

Homework will be based on extensive amounts of practice, including worksheets, knowledge quizzes and past paper questions

Entry Criteria –

Grade 7 in Physics GCSE (separate or combined)

Must also do Maths A level



The qualification we offer is:
Edexcel A Level Politics

In Y12 you will study:

1. UK Politics

Democracy and participation; political parties; electoral systems; voting behaviour and the media.

2. UK Government

The constitution; Parliament; Prime Minister and executive; relationship between the branches.

3. Political Ideologies

Liberalism; Conservatism; Socialism; Feminism

Choose Politics if you like:

An A Level in Politics demands that you ask questions about the world around you: *Why did the UK vote to leave the EU? What are the limits on the powers of the US President? How has feminism changed, and influenced politics, over time?* By studying Politics, you will be equipped to tackle these questions directly. It is a subject which is driven by debate and which will develop you into an analytical thinker. Choose A Level Politics if you want to study current affairs as an expert and learn to express your ideas fluently in writing.

An A-level in Politics can lead to:

A Level Politics equips you with the analytical skills sought by many academic disciplines and professions including journalism, local and national politics, law, consultancy, NGOs and the charity sector.

Example exam questions:

Evaluate the view that the image of the party leader is the most significant factor in determining the result of a general election. [30]

To what extent do feminists agree over the role of the state? [24]

Homework:

- Weekly extended reading, Pre-Chewed politics videos and questions
- Weekly essay

Entry Criteria

Grade 6 in GCSE English Literature or History



The qualification we offer is:

AQA A Level Design and Technology: Product Design

In Y12 you will study:

- **Technical Principles:** Materials, Testing, Industrial & commercial practice, Digital design, Rapid prototyping
- **Practical Project:** You will produce a 30-page portfolio and practical project using 3 different materials.

Choose Product Design if you like:

Finding solutions to problems. If you are passionate about the design of objects from simple everyday products to grand architectural projects. Our subject will explore how designers meet the needs of clients and create solutions in the same way that a modern designer brings a product from a simple idea into the real world. There are two written papers and a practical design and make project all three of which are submitted in Y13.

An A-level in Product Design can lead to:

An A-Level in Product Design can be a stepping-stone towards courses and careers in the world of Design and Engineering. Typically, students go on to careers in: Product Design, Industrial Design, Fashion Design, Engineering and Architecture. Whether you choose to follow a career in design or not, the nature of problem solving and appraising the designed world we live in, will lend skills to a variety of university courses.

An example exam question is:

Using specific examples, evaluate the social, moral and ethical impact of mobile technology on society over the last 30 years. [12 marks]

Homework:

- Weekly design theory reading and creating supporting notes
- Weekly practice including past paper questions and design skill tasks.

Entry Criteria

Grade 6 in Design and Technology GCSE



The qualification we offer is:

AQA A-level Psychology

In Y12 you will study:

Social influence, Memory, Attachment, Approaches in Psychology, Psychopathology and Research methods

Choose Psychology if you like:

Psychology is the study of the human mind and behaviour. Psychologists study and design experiments to find out what is normal human behaviour and then carry out research into abnormal behaviour. You will learn how to evaluate conflicting theories about the topics you cover, and the studies that support, or challenge, them.

An A-level in Psychology can lead to:

Some A-level psychology students will go on to study the subject in isolation as an undergraduate degree however it is also a great precursor to studying sciences, social sciences, arts and humanities courses. Psychology paves the way for many interesting careers within healthcare, research, social care, the arts and beyond.

Example exam question:

Describe the phonological loop component of the working memory model. [3 marks]

Outline techniques used in the cognitive interview and discuss the effectiveness of each of these techniques on the accuracy of eyewitness testimony. [8 marks]

Homework:

Homework will be based on extensive amounts of practice, including worksheets, knowledge quizzes and past paper questions

Entry Criteria –

Grade 6 at GCSE English and one other humanities subject



The qualification we offer is:

OCR Religious Studies A Level

You will study:

The joint disciplines of Philosophy, Religion and Ethics in equal measure. You will immerse yourself in the ideologies of some of the deepest thinkers that have walked the earth such as Plato, Aristotle, Kant and Hume.

Choose Religious Studies if you like:

If you like to learn about the belief systems of others and investigate your own ethical and moral perspectives. If you enjoy exploring the deeper questions such as 'why we exist' and the nature of God.

An A-level in Religious Studies can lead to:

This course opens up pathways to several different avenues due to the logical and critical thinking skills that are developed. Students often go on to study Philosophy, Sociology, Law and similar humanities based subjects at university. These allow students to go on to professions such as teaching, law enforcement and local government.

Example exam question:

'Conversions are not genuine examples of religious experience.' Discuss. [40]

'Paley's teleological argument successfully defends the existence of God.' Discuss. [40]

Evaluate Plato's view on the hierarchy of the Forms, including the Form of the Good. [40]

Homework:

Weekly quizzes and exam style questions

Entry Criteria –

Grade 6 English GCSE and any other humanities subject



The qualification we offer is:
AQA A Level Sociology

In Y12 you will study:

- **Education and methods in context:** You'll consider the role of education in society. For example as part of your studies you'll investigate gender and ethnicity differences in school achievement. You'll also learn how to apply your own sociology research methods to the study of education.
- **Research methods:** You'll learn how to conduct your own sociological research, from interviews to reviewing documents and official statistics.

Choose Sociology if you like:

A Level Sociology gives you the opportunity to question everything about society. As part of your studies, you'll develop your understanding of key issues relating to class, gender, ethnicity, inequality and power. Why are certain groups more likely to commit crime more than others? Why do girls outperform boys in education, yet men still earn more on average than females? These are the questions that sociologists aim to answer. You'll develop skills such as essay writing, analysis, evaluation, critical thinking, teamwork and independent research. These skills are good preparation for university courses and complement many other humanities and social science subjects.

An A-level in Sociology can lead to:

Sociology is a great choice of subject for people who want a career in social work, nursing or medicine. The subject is also useful in several other careers, like marketing, politics, advertising, PR, journalism, law or teaching.

Example exam questions:

Outline three reasons for gender differences in educational achievement. [6 marks]

Applying material from Item B and your knowledge, evaluate sociological explanations of social class differences in educational achievement. [30 marks]

Homework:

- Weekly reading of primary texts from key thinkers
- Completion of set tasks in homework booklets

Entry Criteria –

Grade 6 at GCSE English and any other humanities subject



The qualification we offer is:
AQA A Level Spanish

In Y12 you will study:

1. Social issues and trends
2. Political and artistic culture
3. Grammar

Choose Spanish if you like:

An A level in Spanish will build upon your existing knowledge gained at GCSE, giving you a sound understanding of using your language in a variety of contexts and situations - at home, abroad, with friends or in the workplace. It will also introduce you to the wonders of Spanish literature and film.

An A-level in Spanish can lead to:

Spanish is spoken by over 450 million people across the world and is the second most spoken language in the world, after Mandarin. Being able to speak Spanish can provide you with a multitude of travel and work opportunities. The qualification is viewed favourably across business, arts, travel and legal sectors as well as in politics and translation. Spanish can be taken in conjunction with many other humanities subjects at degree level, or as a stand-alone course.

Example exam question:

“En esta novela las acciones de los personajes son el resultado de fuerzas que no controlan”. ¿Hasta qué punto estás de acuerdo con esta afirmación?

Justifica tu respuesta. [40 marks]

“El orgullo del coronel tiene la culpa de su pobreza”. ¿Hasta qué punto estás de acuerdo con esta afirmación? Justifica tu respuesta. [40 marks]

Homework:

- Weekly comprehension & extended writing tasks
- Vocabulary learning
- Oral practice where relevant

Entry Criteria –

GCSE Spanish grade 7



**The qualification we offer is:
AQA A Level Theatre Studies**

In Y12 you will study:

1. Practitioners in Practice
2. Exploring, devising & Performing
3. Analysing Performance
4. Deconstructing Performance

Choose Theatre Studies if you like:

Are you curious about issues and ideas and have a creative instinct for communicating your views through drama? Are you keen on acting, writing or on the visual and technical side of theatre? Are you interested in going to the theatre to see plays? If you can answer yes to all of these questions, Drama and Theatre Studies is probably for you.

An A-level in Theatre Studies can lead to:

Drama and Theatre Studies can lead to further study in drama, theatre studies and performing arts in higher education at degree level or drama school. It can be studied in conjunction with a humanities subject such as English or History at degree level and may lead on to a career in the performing arts industries, media, law, journalism and beyond.

Example exam question:

As a director, explain and justify how you could use staging in a present-day performance of Antigone. [30]

Homework:

- Weekly reading & extended writing tasks
- Theatre trips as directed
- Rehearsals as directed

Entry Criteria –

GCSE grade 6 Drama or English



What's the entry criteria for a place in your Sixth Form?

The overall Sixth Form entry criteria is as follows:

- 5+ EN/MA
- 6+ in chosen A-Level subjects and/or
- 7+ in Biology, Chemistry, Physics, Maths
- 8+ in Further Maths

How many subjects should I choose?

- Nearly all Sixth Formers at The Totteridge Academy will take three A-levels; it is rarely advantageous to take any more than this.
- Some students will elect to take an EPQ alongside their three subjects; this will begin at the end of Year 12 and will be subject to an application process.
- Some students will elect to take further maths as part of a four A level combination – this combination will always include maths A-level.

How do I know which subjects to choose?

Tonight is a great opportunity to speak to teachers and students about your choices. In line with guidance from UCAS (the national university application system), we also encourage you to –

1. Look at what subjects you are likely to enjoy and be good at. If you enjoy a subject or have a strong ability in it already, you are more likely to do well. Play to your strengths!
2. Think about which subjects you may need to apply for a particular university course or career. It is generally a good idea to study subjects in a similar 'cluster' to where you hope to study/work in the future, e.g. A student thinking they want to study Law at university would be wise to do subjects that have a focus on use of language to argue a point, such as English, History and Sociology.
You can find further guidance on this here <https://www.ucas.com/explore/subjects>
3. Consider 'keeping your options open' and doing a range of subjects if you're unsure which university course, apprenticeship or career you currently wish to pursue.

What if I change my mind about my subjects?

There will be a short window at the start of autumn term whereby a student – in consultation with their form tutor and parents/ carer – can request a subject change.



How do the Sixth Form and tutors support students with the demands of A levels and progression to life after school?

We believe passionately in helping you adjust to the different challenges of Sixth Form and A levels, as well as helping inspire and prepare you for life after you leave school. We run a blog called *Early Bird* which has entries nearly every day with exciting new opportunities for students to grow beyond the classroom, and to inspire them to dream big. Opportunities range from free mentoring for young women interested in Tech careers, free lectures at LSE, getting work experience with the NHS, free talks at Harrow School from prominent politicians and writers, as well as corporate work experience with top tier law firms and investment banks.

Our weekly tutor time programme has been carefully crafted and structured and helps prepare students for A level life as well as their future post-18:

Mondays: tutors present the Early Bird opportunities, encouraging students to apply. They also spend time doing 1-1 catch ups with students, helping those struggling with organisation, or prioritizing their tasks for the week. In Year 13 this time is spent doing university applications.

Tuesdays: every week an article is picked from a broadsheet newspaper or journal which is based on an important current affairs topic, or ethical issue that is pertinent. Students read this as a tutor group, and discuss/debate the main arguments

Wednesdays: students engage in 'super-curricular' reading in their chosen subject in order to deepen their knowledge of academic topics in the subject they are most likely to study at university, or pursue as a career.

Thursday: PSHCE day sees students' education enriched through a curriculum that teaches them core life skills (how to write a CV, a cover letter), core life knowledge (how mortgages, insurance, credit cards, and budgeting works) as well as their moral and spiritual education (we want our Sixth Formers to be fantastic citizens as well as high achieving academically)

Friday: Assembly where we focus on celebrating student achievement, and where a programme of external speakers deliver inspiring lectures, talks, and present exciting opportunities to our students to enrich their lives



What events & extra-curricular activities do you run?

We run a range of exciting events, clubs and competitions. These include:

- Wellbeing Wednesdays – students choose between a wide variety of activities including football, netball, yoga, Art Therapy, and Board Games club
- Oxbridge club
- Debate Club
- Art Club
- Othello & A Streetcar Named Desire screenings
- Studio Club - Drop by the Music Rooms to compose & record your own tracks

We also run a wide variety of trips, both in the UK and abroad (e.g. TTA ski trip)

Speak to subject teachers tonight to find out more!

Do you offer Level 3 courses other than A-levels?

Not at the moment as our teacher expertise is in A-level courses: if you have any questions about what course is right for you, speak to staff tonight or email us.

How many lessons will I have per week?

We run a two-week timetable. You will have 6 x 100-minute lessons per subject across the two weeks.

When will I sit exams?

Students will sit formative assessments in all subjects over the course of Year 12, as directed by their subject teachers. All A-levels are two-year courses with final exams taken at the end of Year 13. Some subjects may include coursework tasks which contribute to a student's final grade.

How much homework is there?

Departments have autonomy to set homework as per the needs of their subject. The options booklet outlines typical homework for each course. As a general rule, you can expect your A-level teachers to set 100 minutes of work outside the classroom for every 100 minutes you are in the classroom.